

• ethengineering •

FOR QUALITY
PRODUCTION
FOR YOUR
SAFETY



CE

www.ethmuhendislik.com

ABOUT US

ETH Engineering was established in 2017 by team members who formerly worked at BORUSAN ENGINEERING for many years.

ETH Engineering has adopted all corporate approaches of BORUSAN Group and aims to differentiate with customer focus and innovative solutions.

ETH Engineering is an engineering company that provides Coil, Plate/Sheet Handling Equipment design and manufacturing, Plant Relocation, Industrial Plant Installation, Machine Design and Manufacturing, Industrial Maintenance and Revision services.

Eth Engineering **"Provides solutions to your needs."**

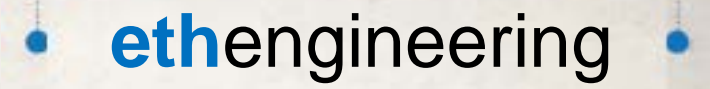

**RELOCATING YOUR PLANT
IS VERY EASY FOR US**

HORIZONTAL COIL HANDLING TONG

The tong is used for the handling of horizontal coils and has the feature of two way infinite rotation. Thanks to its 3 different body options, it also enables the handling of large coils. Other Features are:

- Load sensing mechanism
- Bar closing mechanism
- Coil centering sensor (4 pcs.)

Thanks to the load sensing mechanism and bar closing switches, the safety of the load, the equipment and the user is ensured.

When the coil is centered by coil centering sensors, then the operator is notified by a green warning light. At the same time, arm closing function becomes active, thanks to touch pads touching the coil, to prevent damage.

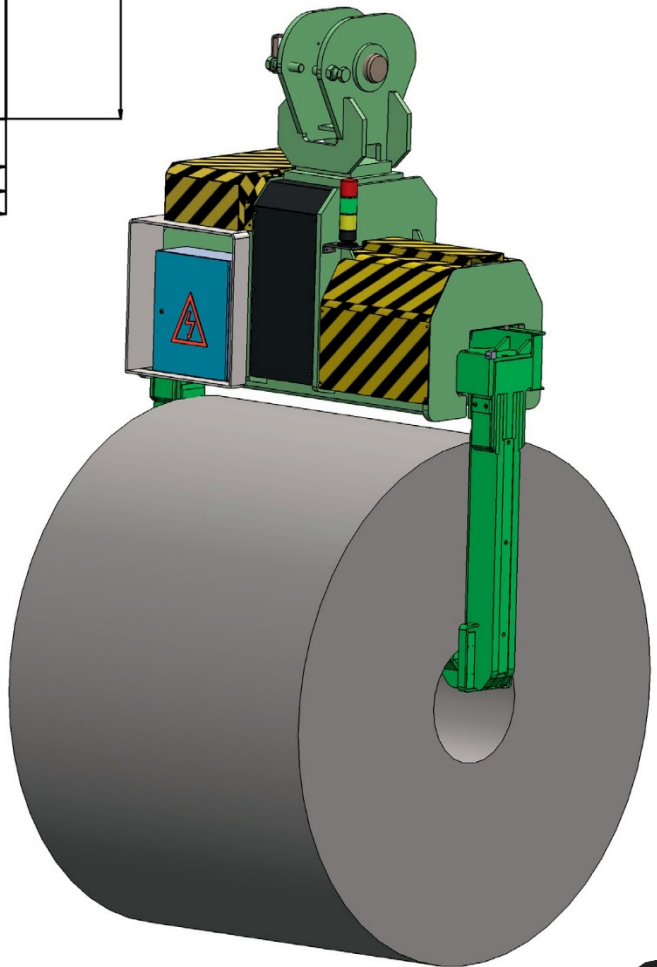
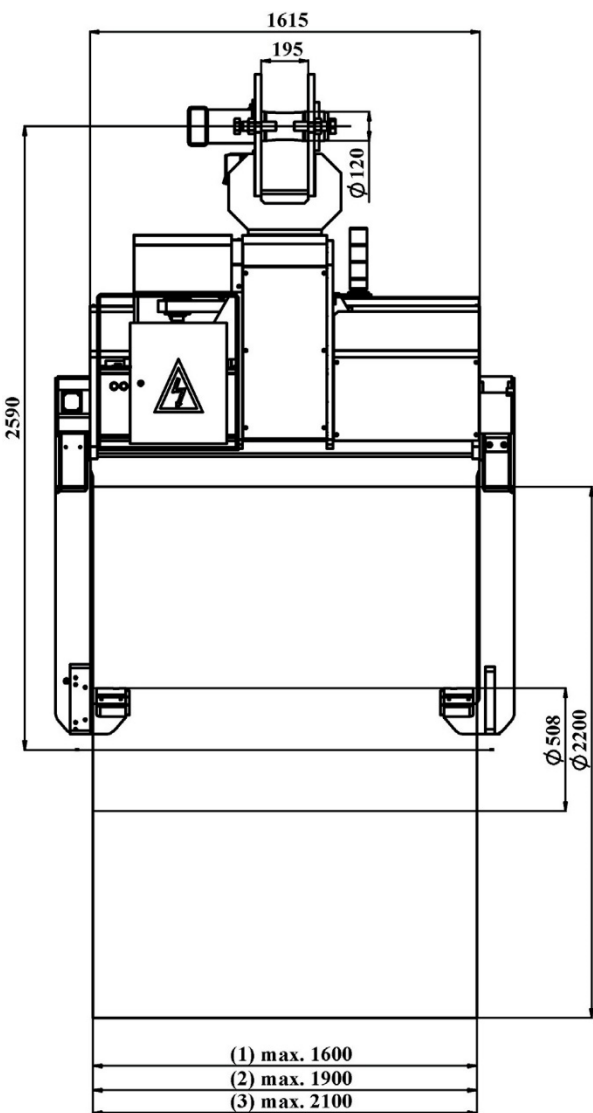

Technical Specifications

Coil Width (min.-max.) 1:	600 - 1600 mm
Coil Width (min.-max.) 2:	600 - 1900 mm
Coil Width (min.-max.) 3:	600 - 2100 mm
Coil Diameter (max.):	2200 mm
Load Capacity (max.):	20, 30, 40 ton
Coil Internal Diameter:	508 - 610 mm

* For non-standard coils, custom-made designs may also be available.



PLATE/SHEET HANDLING TONG

- Plate Product Handling Tong**
- Load sensing mechanism
 - Bar closing mechanism
 - Thanks to the load sensing mechanism and bar closing switches, the safety of the load, the equipment and the user is increased.

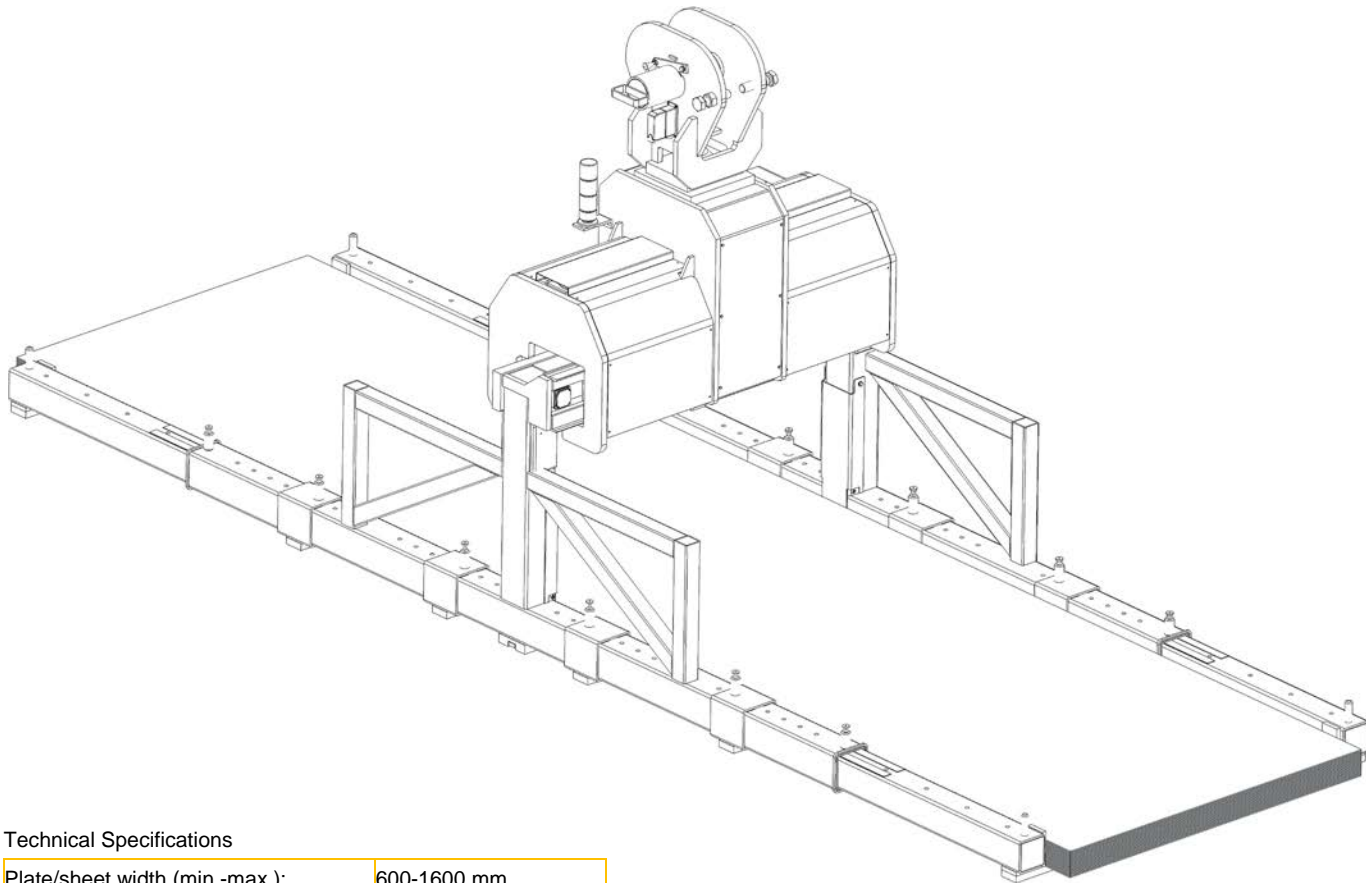
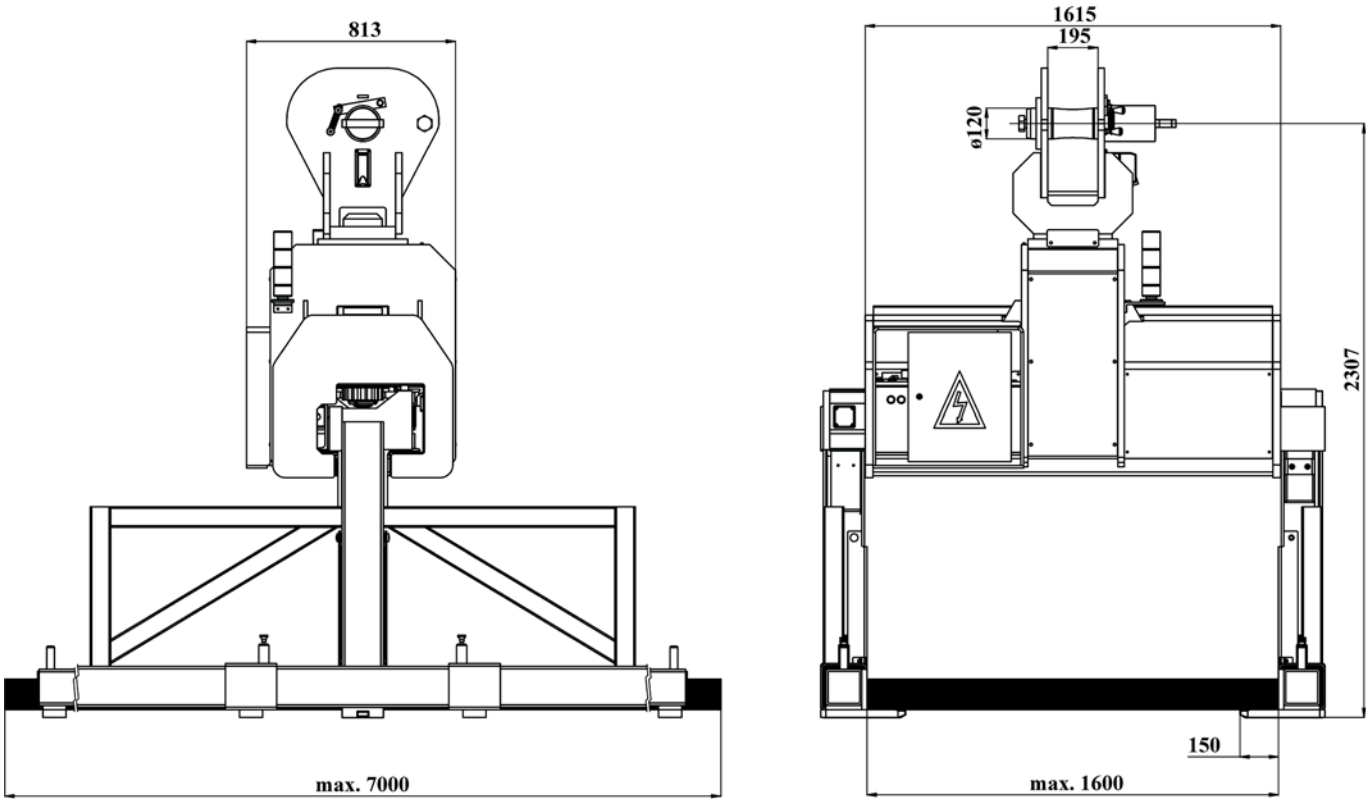
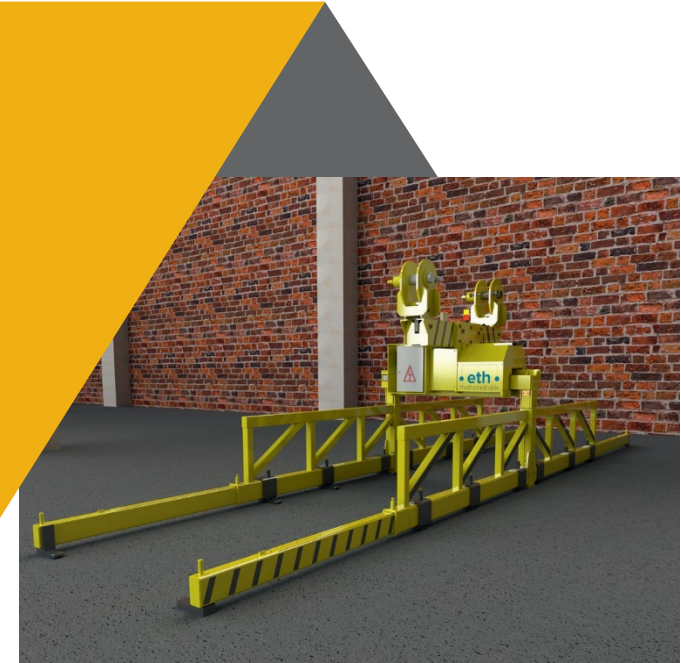

Technical Specifications

Plate/sheet width (min.-max.):	600-1600 mm
Plate/sheet length (max.):	7000 mm
Load capacity (max.):	10 ton

* Design for non-standard plate/sheet sizes, custom-made designs may also be available.

VERTICAL COIL HANDLING TONG

Thanks to mechanical clamping feature, the handling of vertical coils are achieved.

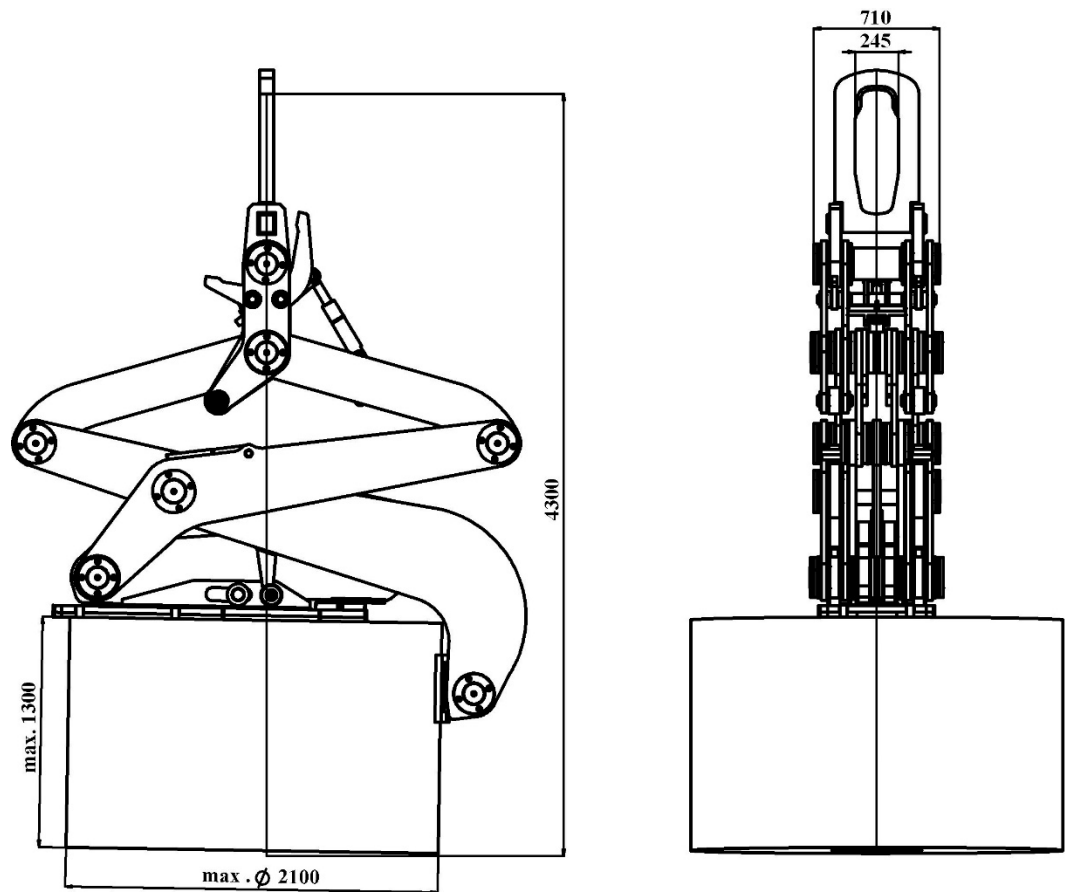

Technical Specifications

Coil Internal Diameter:	508 - 610 mm
Coil Width (min.-max.):	600-1300 mm
Coil Diameter (min.-max.):	1000-2100 mm
Load Capacity (max.):	30 ton
Max Length Opening :	6400 mm

* For non-standard coils, custom-made designs may also be available



SLIT VERTICAL COIL HANDLING TONG

The tong is used for handling various wide-width, eye to sky products standing on pallet.

Features are:

- Load sensing mechanism
- Bar closing mechanism
- Thanks to the load sensing mechanism and bar closing switches, the safety of the load, the equipment and the user is increased.

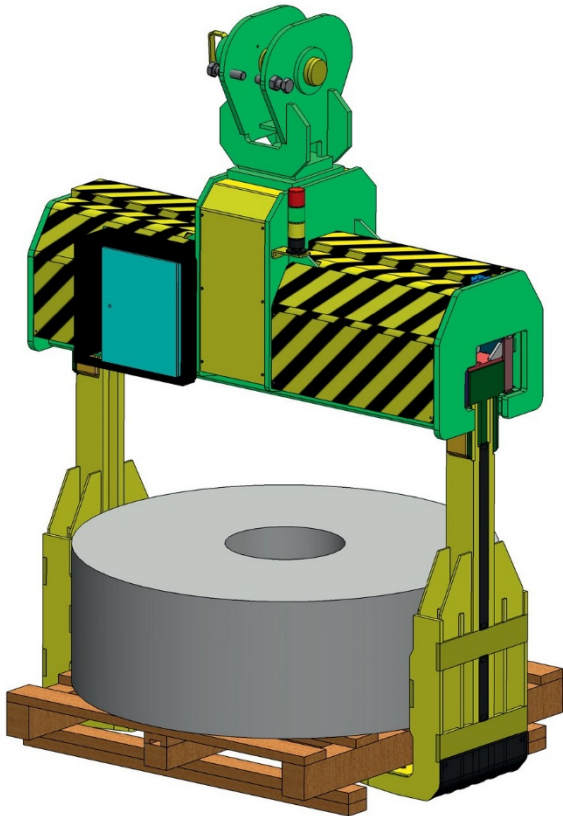
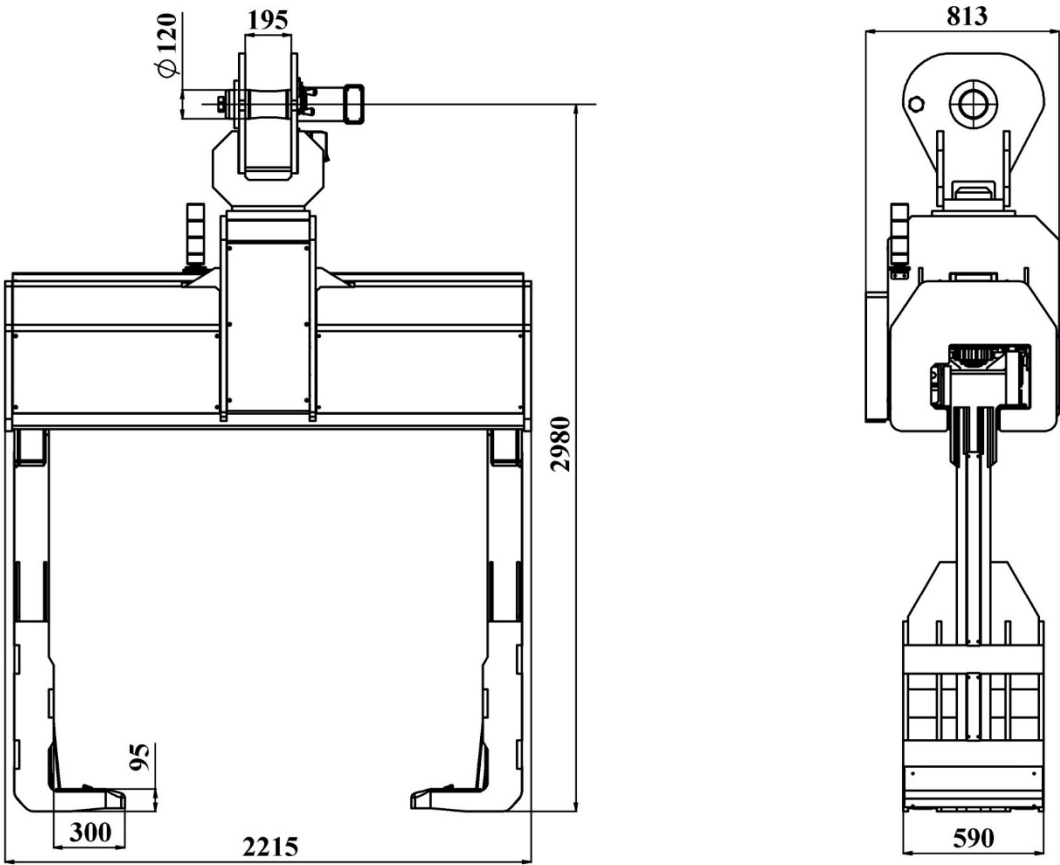

Technical Specifications

Coil Width (max.):	1300 mm
Coil Diameter (min.-max.):	700-1800 mm
Load Capacity (max.):	15 ton

* For non-standard coils, custom-made designs may also be available



HORIZONTAL COIL HANDLING TONG WITH FOLDABLE FEET

The tong is used for Horizontal Coil Carriage. Features two-way infinite rotation. Thanks to the folding feature of the coil feet, the gap between the coil racks is minimized and the stock areas occupancy rate is increased.

Other features are:

- Load sensing switch mechanism
- Bar closing switch mechanism
- Coil centering sensor (4 pcs.)

Thanks to the load sensing and bar closing switches, the safety of the load, the equipment and the user is increased.

When the coil is centered by coil centering sensors, then the operator is notified by a green warning light. At the same time, arm closing function becomes active, thanks to touch pads touching the coil, in order to prevent damage.



CE

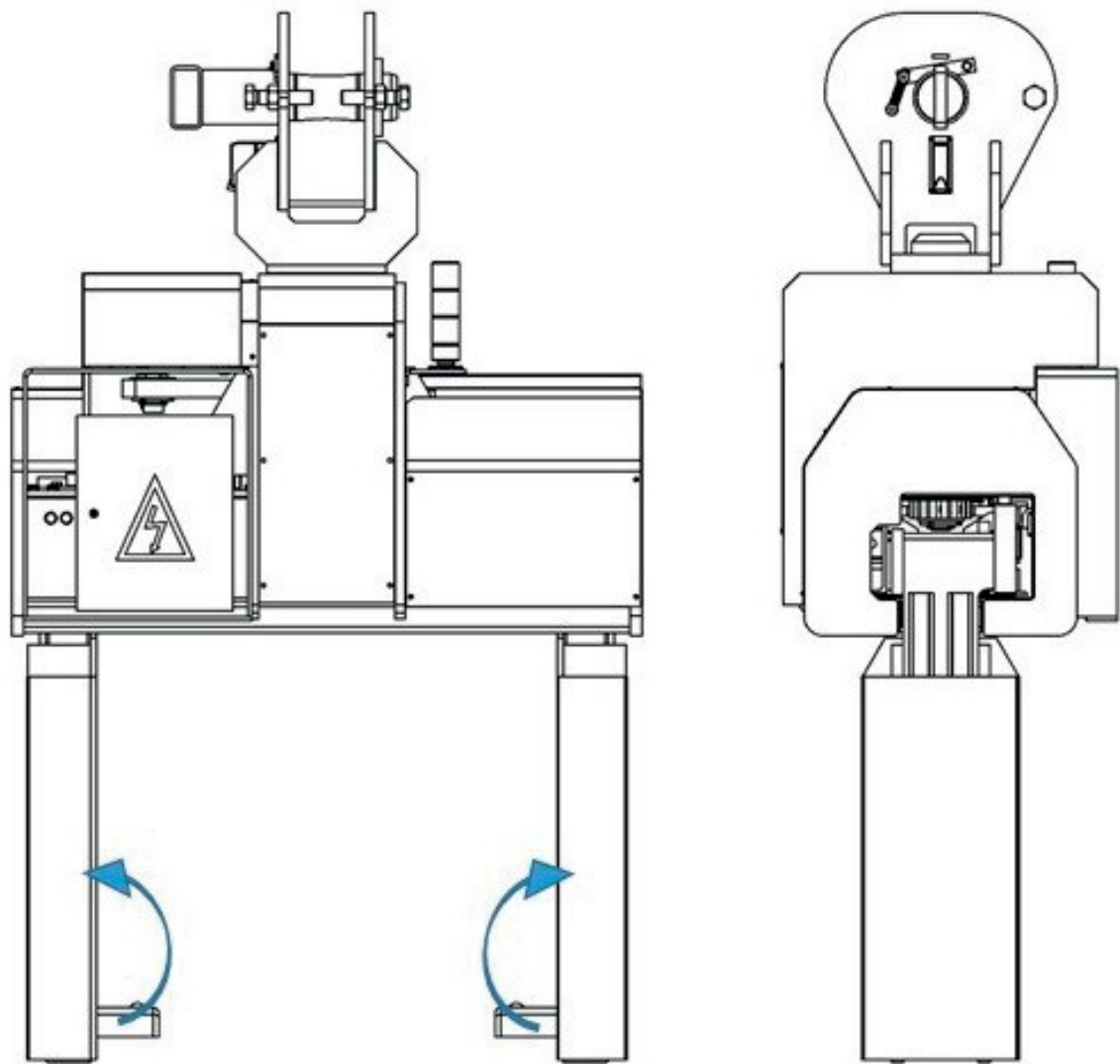

Technical Specifications

Coil Width (min.-max.) 1:	600-1600 mm
Coil Width (min.-max.) 2:	600-1900 mm
Coil Width (min.-max.) 3:	600-2100 mm
Coil Diameter (max.):	2200 mm
Load Capacity (max.):	30 ton
Coil Internal Diameter	508 - 610 mm

For non-standard coils, custom-made designs may also be available

CE

ROTATING “C” HOOK

The hook is used for handling of horizontal coils and slit coils. The rotation is both ways and endless. Using counter balance weight, the position of the hook is maintained at secure angles. Any handling damage to the coil is prevented via internal diameter and side wall coverings. The desired rotation position is achieved thanks to the drive engine with brakes.

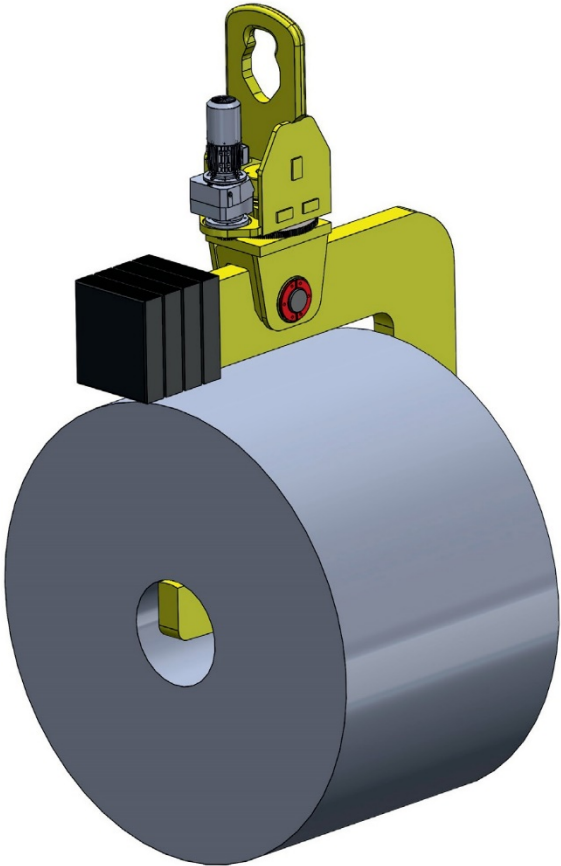
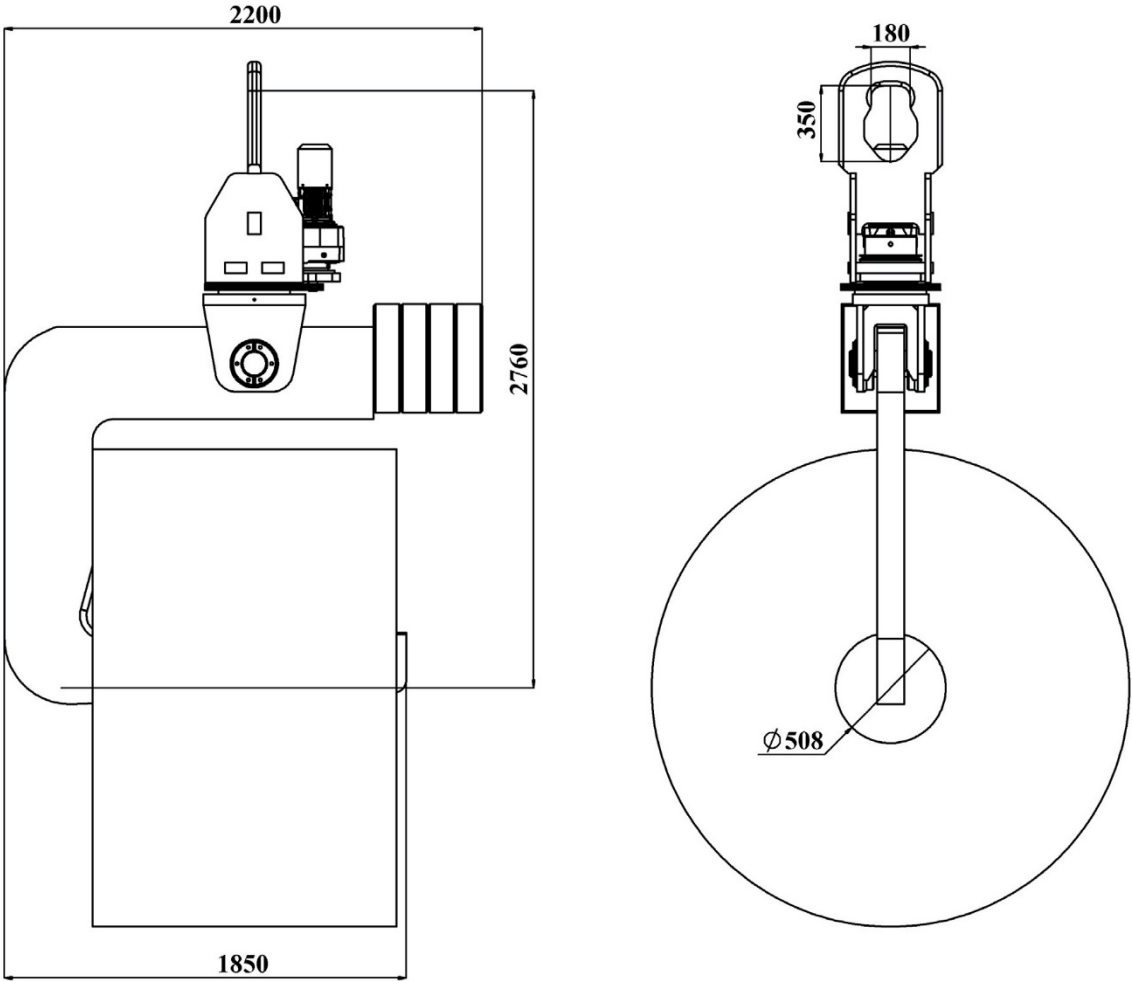

Technical Specifications	
Coil Width (max.):	1400 mm
Coil Diameter (max.):	2200 mm
Load Capacity (max.):	30 ton
Coil Internal Diameter:	508 - 610 mm

* For non-standard coils, custom-made designs may also be available

COUNTER BALANCED “C” HOOK

The hook is used for handling of horizontal coils and slit coils. Any handling damage to the coil is prevented thanks to the internal diameter and side wall coverings

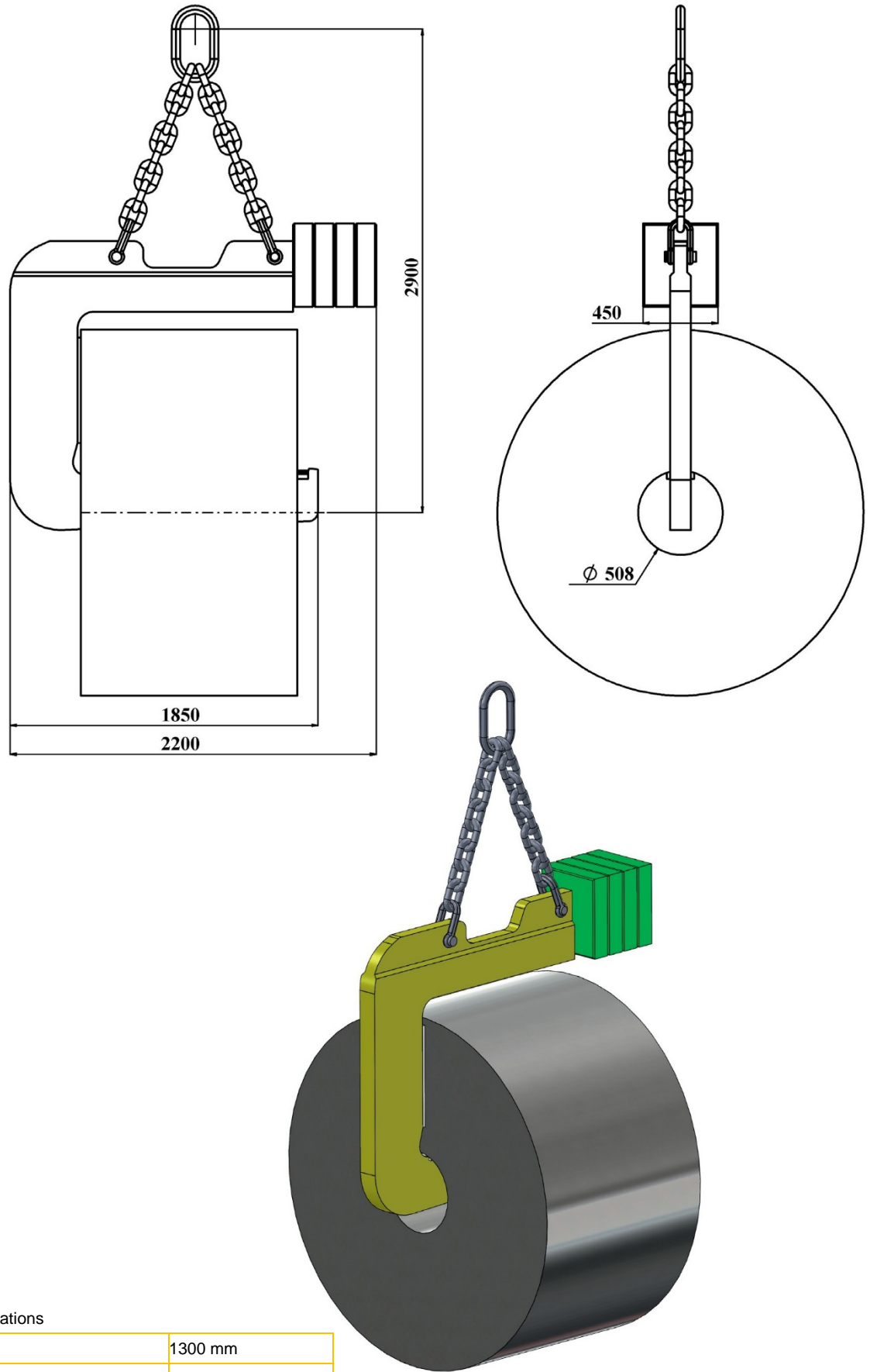
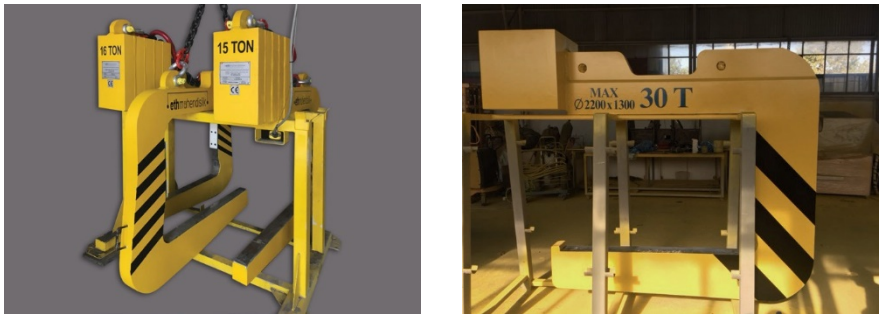

Technical Specifications

Coil Width (max.):	1300 mm
Coil Diameter (max.):	2200 mm
Load Capacity (max.):	30 ton
Coil Internal diameter:	508 - 610 mm

* For non-standard coils, custom-made designs may also be available



The tong is used for vertical (eye to sky) coils.

Technical Specifications

Coil Width (max.):	1300 mm
Coil Diameter (max.):	2200 mm
Load Capacity (max.):	30 ton

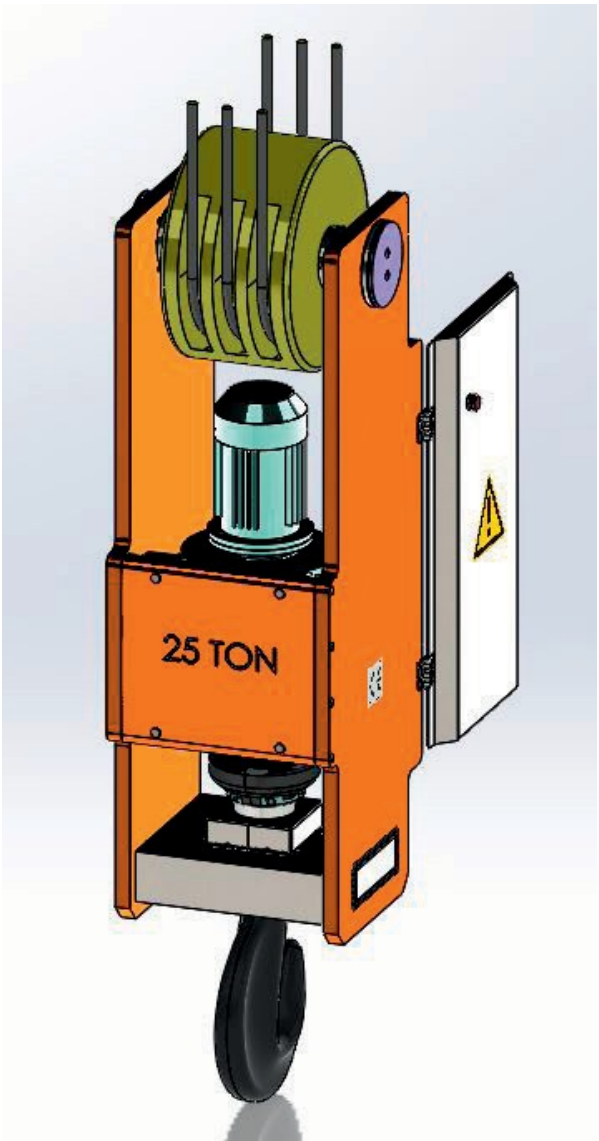
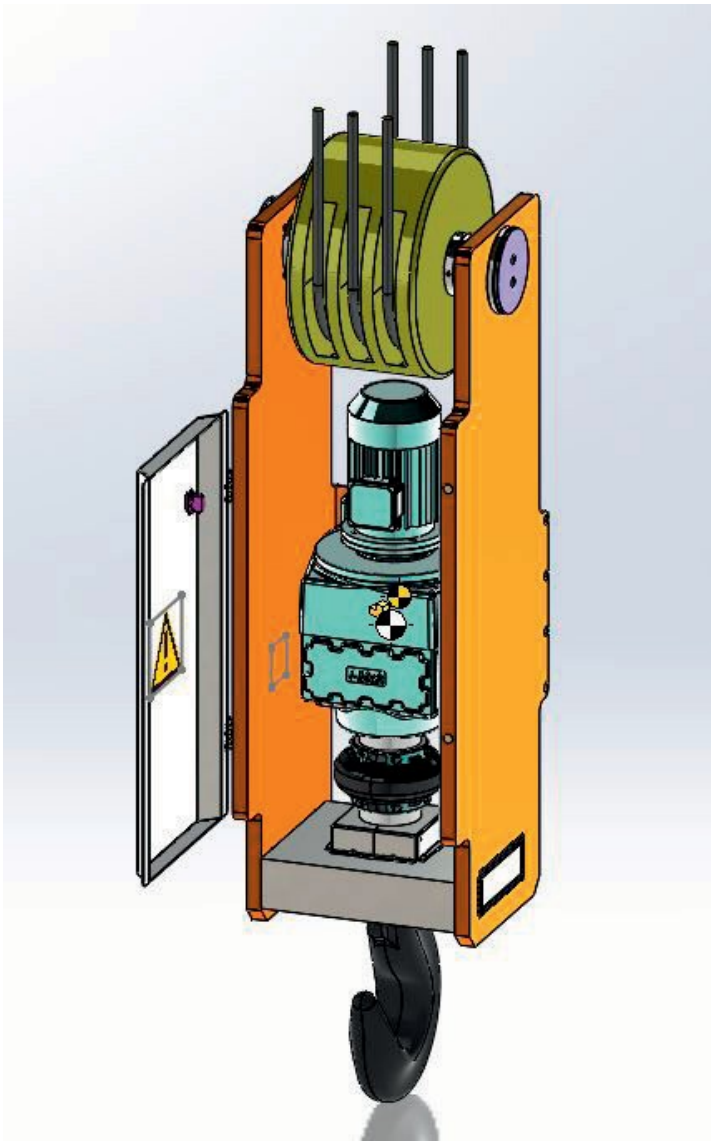

ROLL / SHEET TRANSPORT CAR

ethengineering



CE

"C" HOOK FOR HANDLING AND ROTATING NARROW COILS

ethengineering



CE

AUXILIARY NARROW COIL HANDLING TONG

ethengineering



CE

OUR CERTIFICATES

ethengineering



OUR REFERENCES

ethengineering

- 3M
- Alcos
- ArcelorMittal
- Arçelik
- Asil Çelik
- Atakaş Çelik
- Bağcı Antrepo
- Bemas Metal
- Borçelik
- Borusan Enerji
- Borusan Mannesmann Boru
- Borusan Lojistik
- Borusan Makine ve Güç Sistemleri
- Cesan
- Cargill
- Crown
- CMI
- Çağsoy Tekstil
- Çemtaş
- Çimtaş
- Daikin
- Dalan Kimya
- Daimler Mercedes
- Danieli
- Ebner
- Elba
- Eti Makine
- Ferroli
- Güralp Vinç

- HMY Teknogon
- Hitachi
- Hyundai- Assan
- Isover Saint Gobain
- İpek Kağıt
- İzocam
- Kerim Çelik
- Kordsa
- Matay
- MMK Metalurji
- MPS Metal
- Nestle
- Parsan
- Posco - Assan
- Prysmian Group
- Rekor Kauçuk
- Rhea Marine
- Roda Liman
- A.Schulman
- Sarıtaş Paslanmaz
- Siemens VAI
- Silvan Sanayi
- SMS Siemag
- Thyssenkrupp
- Tezcan Galvaniz
- Teknorot
- Tosyalı-Toyo
- Tat Metal
- Yorim Cam
- Yıldız Demir Çelik

